

# DATA SHEET



## Three Phase Induction Motor - Squirrel Cage

Customer :				
Product line : W21 Explosion Proof NEMA Premium Efficiency Three-Phase		Product code : 14406916		
		Catalog # : 02518XT3E284TC		
Frame : 284TC	Insulation class : F	Cooling method : IC411 - TEFC	Mounting : F-1	
Duty cycle : Cont.(S1)	Ambient temperature : -20°C to +40°C	Rotation <sup>1</sup> : Both (CW and CCW)	Starting method : Direct On Line	
Altitude : 1000 m.a.s.l.	Protection degree : IP55	Approx. weight <sup>3</sup> : 448 lb	Moment of inertia (J) : 4.54 sq.ft.lb	
Design : B				
Output [HP]	25		25	
Poles	4		4	
Frequency [Hz]	60		50	
Rated voltage [V]	230/460		380	
Rated current [A]	59.0/29.5		35.9	
L. R. Amperes [A]	366/183		190	
LRC [A]	6.2x(Code G)		5.3x(Code F)	
No load current [A]	22.0/11.0		11.0	
Rated speed [RPM]	1770		1455	
Slip [%]	1.67		3.00	
Rated torque [ft.lb]	74.2		90.2	
Locked rotor torque [%]	240		180	
Breakdown torque [%]	270		210	
Service factor	1.15		1.00	
Temperature rise	105 K		105 K	
Locked rotor time	36s (cold) 20s (hot)		25s (cold) 14s (hot)	
Noise level <sup>2</sup>	68.0 dB(A)		64.0 dB(A)	
Efficiency (%)	25%	91.7	92.9	
	50%	92.4	92.4	
	75%	93.0	91.7	
	100%	93.6	91.0	
Power Factor	25%	0.45	0.52	
	50%	0.70	0.76	
	75%	0.80	0.84	
	100%	0.84	0.86	
Bearing type : 6311 C3	Drive end	Non drive end	Foundation loads	
Sealing : Oil Seal		Lip Seal	Max. traction : 792 lb	
Lubrication interval : 20000 h		20000 h	Max. compression : 1240 lb	
Lubricant amount : 18 g		11 g		
Lubricant type : Mobil Polyrex EM				
Notes USABLE @208V 64.5A SF 1.15 SFA 74.2A				
This revision replaces and cancel the previous one, which must be eliminated. (1) Looking the motor from the shaft end. (2) Measured at 1m and with tolerance of +3dB(A). (3) Approximate weight subject to changes after manufacturing process. (4) At 100% of full load.		These are average values based on tests with sinusoidal power supply, subject to the tolerances stipulated in NEMA MG-1.		
Rev.	Changes Summary		Performed	Checked
Performed by				
Checked by			Page	Revision
Date	12/10/2023		1 / 2	

# DATA SHEET



## Three Phase Induction Motor - Squirrel Cage

Customer : \_\_\_\_\_

### Thermal protection

ID	Application	Type	Quantity	Sensing Temperature
1	Winding	Thermostat - 2 wires	1 x Phase	155 °C

Rev.	Changes Summary	Performed	Checked	Date
Performed by		Page 2 / 2		Revision
Checked by				
Date	12/10/2023			

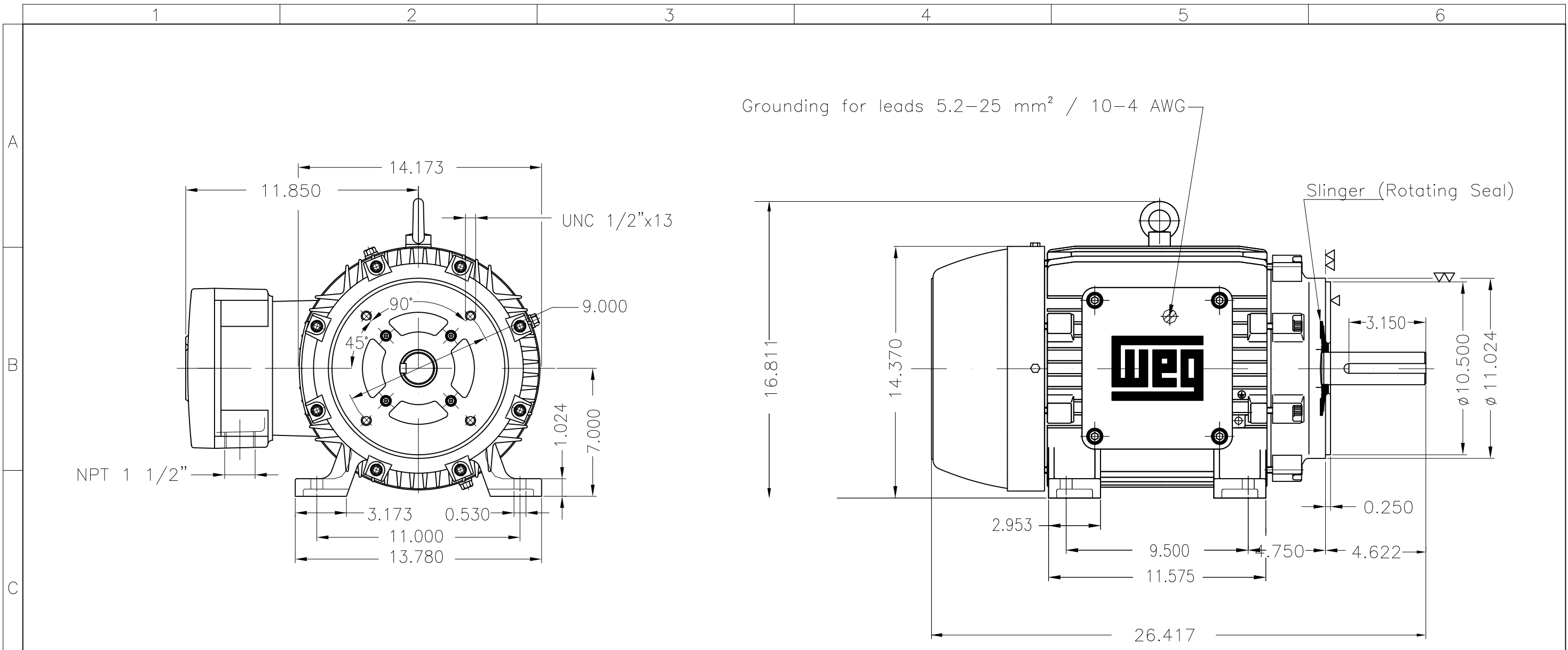

1  
2  
3  
4  
5  
6

A  
B  
C  
D  
E

- With grease fitting
- Color RAL 5009
- Painting plan 222P
- Mounting NEMA F-1
- Mounting B34R(D)

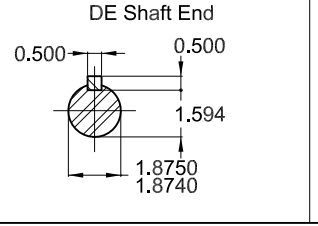

25 HP 04 Poles 60 Hz A

						HYBRISUSER						00	
ECM	LOC	SUMMARY OF MODIFICATIONS				EXECUTED	CHECKED	RELEASED	DATE	VER			
EXECUTED	HYBRISUSER	THREE PH. MOTOR EXPLOSION PROOF		NEMA PREM. EFF.		PREVIEW							
CHECKED		FRAME 284TC IP55 TEFC				WDD		00					
RELEASED						SHEET		1 / 1					
REL. DATE		WMO	Jaragua do Sul	Product Engineering									



MADE IN BRAZIL

**W21X NEMA**  
**Premium**

14406916



LISTED

CC029A

*Inverter Duty Motor*  
*Severe Duty*

MODEL 02518XT3E284TC

PH 3	FR 284TC		
HP(kW) 25.0(18.5)		HZ 60	IP55
V 230/460		A 59.0/29.5	
RPM 1770		NEMA NOM EFF 93.6%	
PF 0.84		SFA 67.8/33.9	DES B
INS CL F $\Delta$ T 80 K		SF 1.15	ENCL TEFC
DUTY CONT.		CODE G	ALT 1000 m.a.s.l.
AMB 40°C			
AMB 55°C SF1.0			
25HP 18.5kW 50Hz 380V 35.9A 1455RPM SF1.00 EFF 91.0% (IE1)			

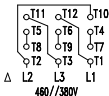
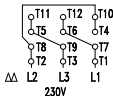

→ 6311-C3 MOBIL POLYREX EM  
→ 6211-C3 18 g 20000 h

448 Lbs



TEMP CODE T3C  
CSA/UL: Class I - Div. 1 - Groups C and D  
CSA: Class II - Div. 1 - Groups F and G  
CSA: Class I - Zone 1 - IIB

EXPLOSION PROOF MOTOR

FOR USE ON VPWM VFD 1000:1VT, 6:1CT, 1.0SF, T3C, AMB 40°C.