

DATA SHEET



Three Phase Induction Motor - Squirrel Cage

Customer :				
Product line : W22 NEMA Premium Efficiency Three-Phase		Product code : 12275877		Catalog # : 06036ET3E364TSC-W22
Frame : 364/5TSC	Insulation class : F	Cooling method : IC411 - TEFC	Mounting : F-1	
Duty cycle : Cont.(S1)	Ambient temperature : -20°C to +40°C	Rotation ¹ : Both (CW and CCW)	Starting method : Direct On Line	
Altitude : 1000 m.a.s.l.	Protection degree : IP55	Approx. weight ² : 876 lb	Moment of inertia (J) : 10.6 sq.ft.lb	
Design : B				
Output [HP]	60		50	
Poles	2		2	
Frequency [Hz]	60		50	
Rated voltage [V]	230/460		380	
Rated current [A]	134/67.0		67.4	
L. R. Amperes [A]	884/442		431	
LRC [A]	6.6x(Code G)		6.4x(Code G)	
No load current [A]	32.0/16.0		15.8	
Rated speed [RPM]	3555		2955	
Slip [%]	1.25		1.50	
Rated torque [ft.lb]	88.6		88.9	
Locked rotor torque [%]	200		190	
Breakdown torque [%]	260		250	
Service factor	1.25		1.00	
Temperature rise	80 K		80 K	
Locked rotor time	25s (cold) 14s (hot)		21s (cold) 12s (hot)	
Noise level ²	79.0 dB(A)		74.0 dB(A)	
Efficiency (%)	25%	91.0	91.1	
	50%	91.7	92.1	
	75%	93.0	92.8	
	100%	93.6	93.7	
Power Factor	25%	0.59	0.60	
	50%	0.81	0.81	
	75%	0.88	0.88	
	100%	0.90	0.89	
Losses at normative operating points (speed;torque), in percentage of rated output power				
Losses (%)	P1 (0,9;1,0)		6.3	6.3
	P2 (0,5;1,0)		4.7	4.7
	P3 (0,25;1,0)		4.4	4.4
	P4 (0,9;0,5)		3.3	3.3
	P5 (0,5;0,5)		1.7	1.7
	P6 (0,5;0,25)		1.1	1.1
	P7 (0,25;0,25)		0.6	0.6
Bearing type	Drive end : 6314 C3	Non drive end : 6314 C3	Foundation loads	
Sealing	: WSeal	: WSeal	Max. traction	: 476 lb
Lubrication interval	: 4000 h	: 4000 h	Max. compression	: 1352 lb
Lubricant amount	: 27 g	: 27 g		
Lubricant type	: Mobil Polyrex EM			
This revision replaces and cancel the previous one, which must be eliminated. (1) Looking the motor from the shaft end. (2) Measured at 1m and with tolerance of +3dB(A).			These are average values based on tests with sinusoidal power supply, subject to the tolerances stipulated in NEMA MG-1.	
Rev.	Changes Summary		Performed	Checked
Performed by				
Checked by			Page	Revision
Date	11/10/2023		1 / 2	

DATA SHEET



Three Phase Induction Motor - Squirrel Cage

Customer :

Notes

USABLE @208V 148A SF 1.10 SFA 163A

Rev.	Changes Summary	Performed	Checked	Date
Performed by				
Checked by			Page	Revision
Date	11/10/2023		2 / 2	

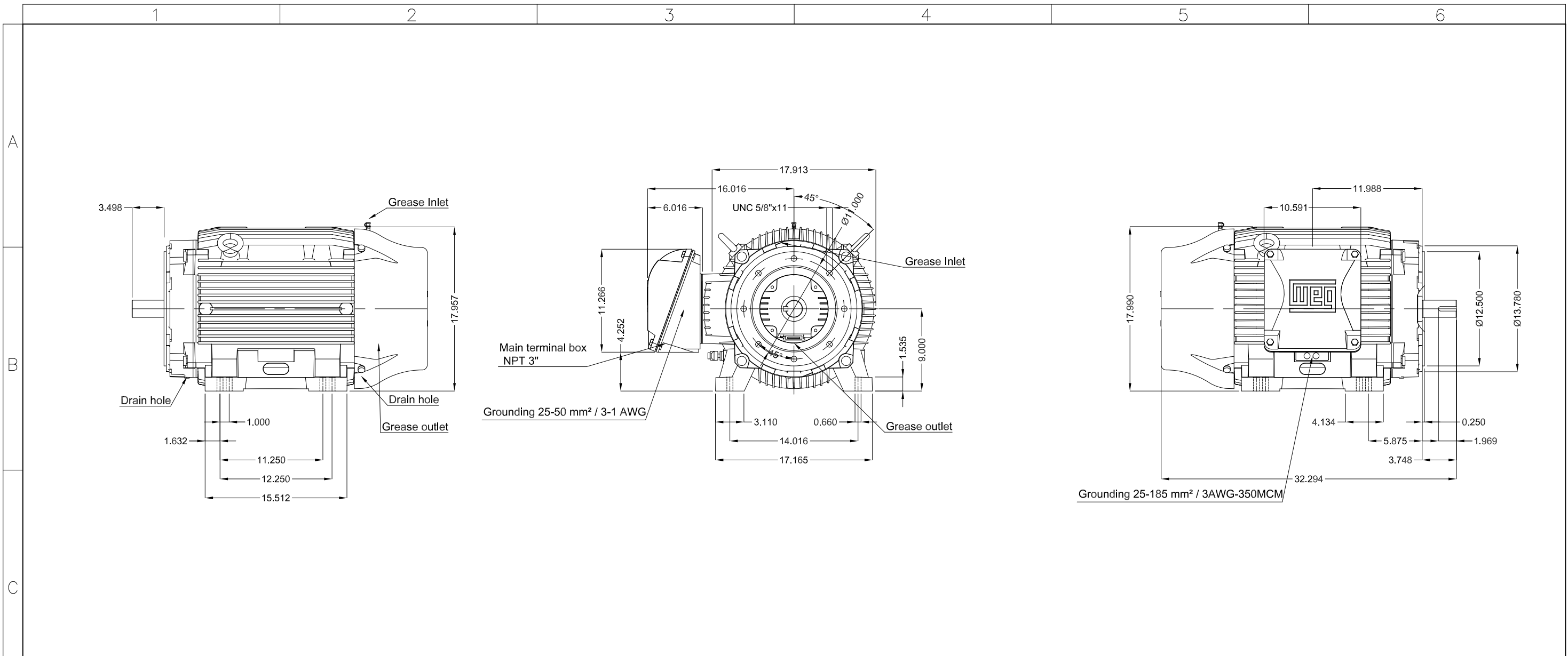

Without vertical jackscrews		Color RAL 5009		Painting plan 203A		Mounting B34R(D)	
60 HP		02 Poles		60 Hz		A	
ECM		LOC		SUMMARY OF MODIFICATIONS		HYBRISUSER	
EXECUTED	HYBRISUSER	THREE PH. MOTOR W22 NEMA PREM. EFF.		EXECUTED	CHECKED	RELEASED	DATE
CHECKED		FRAME 364/5TSC IP55 TEFC		PREVIEW	WDD	00	
RELEASED				SHEET	/		
REL. DATE							

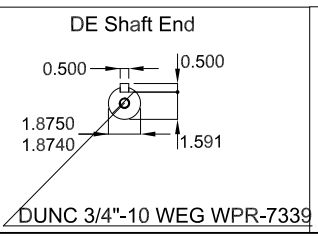

HYBRISUSER	00
EXECUTED	
CHECKED	
RELEASED	
REL. DATE	

Dimensions in inches

A3



For use on 60Hz
 Class I, Div 2, Gr A, B, C and D - T3
 Class I, Zone 2, IIC - T3
 Class II, Div 2, Gr F and G - T4
 For use on PWM: Gr. A, B, C, D and F,
 VT 1000:1, CT 20:1, 1.00SF - T3A

MODEL 06036ET3E364TSC-W22

Inverter Duty Motor
 Severe Duty

PH3 60Hz Fr. 364/5TSC 1000m.a.s.l. IP55 TEFC 876lb

V 230/460 A 134/67.0

HP 60 kW 45

SF 1.25 SFA 168/83.8

RPM 3555 PF 0.90

AMB 40°C INS cl. F DT80K NEMA NOM EFF 93.6%

DUTY CONT. DES B Code G

60HP 45kW 50Hz 380V 83.1A 2935RPM SF 1.00 EFF 92.4% (IE1)

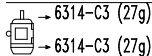
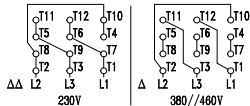

MOBIL POLYREX EM (4000h)

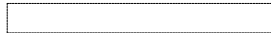

MADE IN MEXICO
 12275877